

Specification

Model	MESF2		
Size	16	20	
Positioning repeatability (mm)	±0.02		
Lead (mm)	2	2	8
Maximum speed *1 (mm/s)	≤50	≤100	≤400
Work load *2 (kg)	Horizontal	3	1.5
	Vertical	0.8	0.8
Pushing force *1,3,4 (N)	18 ~ 60	64 ~ 195	18 ~ 48
Stroke (mm)	30 / 50 / 75	30 / 50 / 75 / 100	
Motor size (mm)	□20	□25	
Rated voltage	DC 24V±10%		

*1. The speed and force may change depending on the cable length, load, stroke and mounting conditions.

*2. The maximum load capacity decreases as the speed increases.

*3. The accuracy of pushing force is ± 20%.

*4. Pushing force for MESF2 is from 30% to 90%.

Motor type Step motor

Transmission Ball screw

Environment Standard

Guide type Cross roller guide

Order example

MESF2 - 16 L02 - 30 - CK10 03 N 015 - XA00

Model

Size	Ball screw lead	Stroke
16	L02	2 mm
	L08	8 mm
20	L02	2 mm
	L08	8 mm
	L10*	10 mm

* Only for size 20

Controller
CK10 *4
CM20 *1

I/O type
N NPN

I/O cable length
015 1.5 m
03 3 m

* Standard: 1.5 m

Power + Encoder cable of motor
01 1 m *2
015 1.5 m *3
03 3 m
05 5 m

* Standard: 3 m

*1. Sensors would be needed.

*2. Only for CM20.

*3. Only for CK10.

*4. Only for size 16.

Speed-load curve diagram

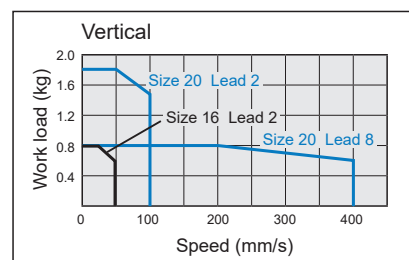
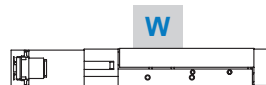
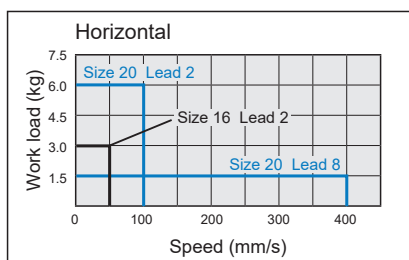

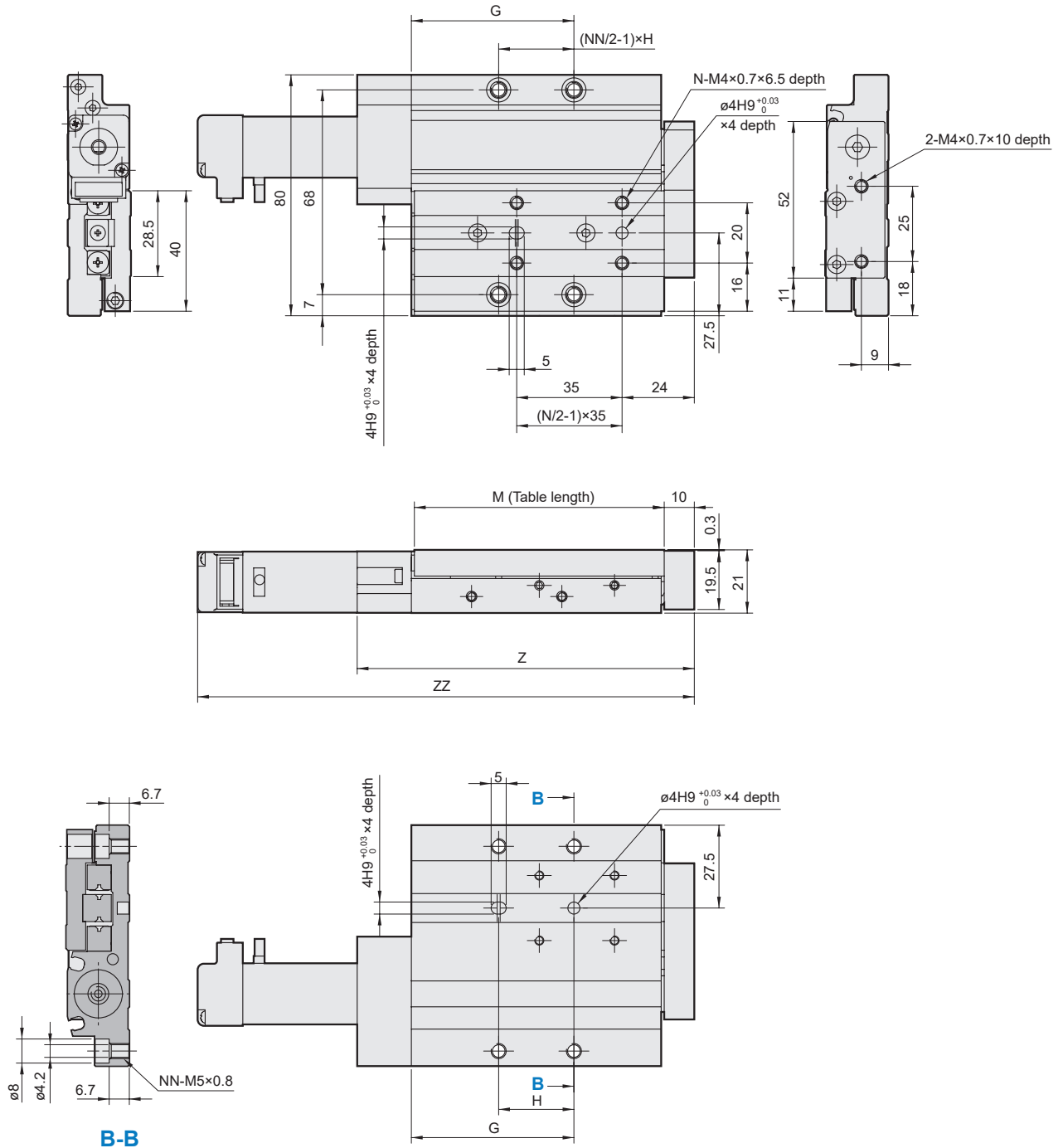

Stroke	N	NN	G	H	M	Z	ZZ	Weight (g)
30	4	4	54	25	83	112	165	516
50	6	4	84	55	113	142	195	691
75	6	6	120	45	159	188	241	910

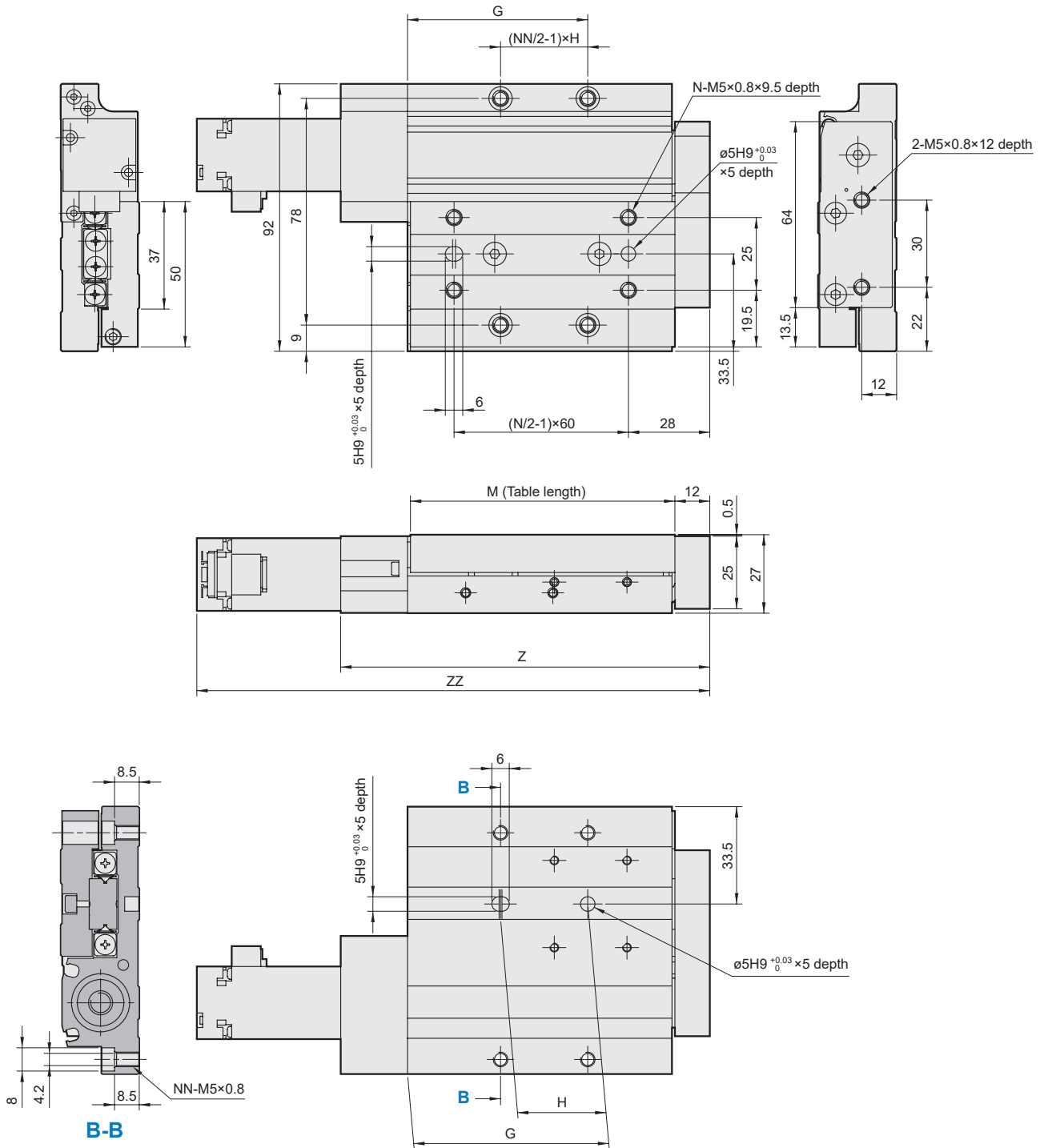

Stroke	N	NN	G	H	M	Z	ZZ	Weight (g)
30	4	4	62	30	91	127	176.5	933
50	4	4	77	45	113	149	198.5	1139
75	6	6	122	45	162	198	247.5	1397
100	6	6	152	60	211	247	296.5	1654